



CHURCHILL
estates



Droveday, Loughton

Asking Price £235,000

Tenure : Leasehold

Floor Area : 430.00 sq ft

Local Authority : Epping Forest

Council Tax Band : B

Bedrooms : 1

Receptions : 1

Bathrooms : 1



Energy Efficiency Rating

	Current	Potential
Very energy efficient - lower running costs		
(92 plus) A		
(81-91) B		
(69-80) C		76
(55-68) D	50	
(39-54) E		
(21-38) F		
(1-20) G		
Not energy efficient - higher running costs		
England & Wales		EU Directive 2002/91/EC 



This well-maintained one-bedroom flat offers a perfect blend of comfort and convenience. Spanning approximately 430 square feet, this purpose-built apartment is situated on the second floor, providing a peaceful retreat from the hustle and bustle of daily life. The property features a welcoming reception room, ideal for relaxation or entertaining guests. The bedroom is spacious and bright, ensuring a restful night's sleep. The bathroom is well-appointed, catering to all your daily needs. One of the standout features of this flat is its long lease and low service charges, making it an attractive option for both first-time buyers and investors alike. Additionally, residents benefit from communal parking, providing ease of access for those with vehicles. Location is key, just 1.2 miles from Debden Central Line station and 1.8 miles from Loughton Central Line station, commuting to London and beyond is straightforward. Furthermore, bus routes are conveniently located on your doorstep, and the M25 and M11 motorways are easily accessible for those who prefer to drive. For your everyday needs, a variety of amenities are within walking distance, and the vibrant Loughton High Street is just moments away, offering a delightful selection of shops, cafes, and restaurants. In summary, this charming one-bedroom flat in Droveway presents an excellent opportunity for those seeking a comfortable home in a well-connected area with its appealing features and prime location.







- CHAIN FREE
- AMENITIES NEARBY
- LONG LEASE
- ELECTRIC HEATING
- WELL LOCATED
- EASY ACCESS TO PUBLIC TRANSPORT
- LOW SERVICE CHARGE





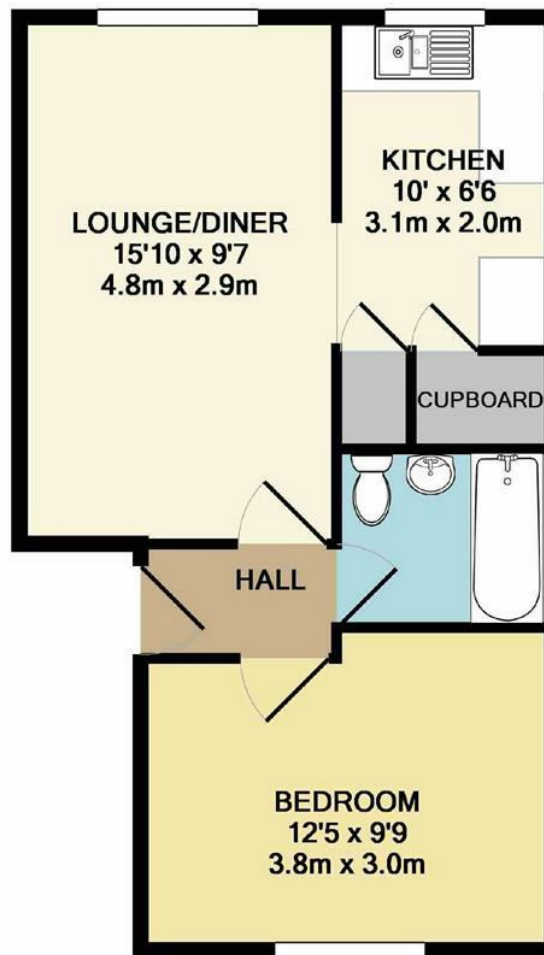

TOTAL APPROX. FLOOR AREA 406 SQ.FT. (37.7 SQ.M.)

Whilst every attempt has been made to ensure the accuracy of the floor plan contained here, measurements of doors, windows, rooms and any other items are approximate and no responsibility is taken for any error, omission, or mis-statement. This plan is for illustrative purposes only and should be used as such by any prospective purchaser. The services, systems and appliances shown have not been tested and no guarantee

as to their operability or efficiency can be given

Made with Metropix ©2019

Email buckhursthill@churchill-estates.co.uk

To view call **0208 504 2222**

CHURCHILL
estates